

FS-1000

組立／取扱説明書 INSTRUCTION MANUAL

組立て前の注意 BEFORE YOU BEGIN

- L R** 左右同じように組立てる。
Assemble left and right sides the same way.
- 別購入品**
Must be purchased separately!
- 2mm** 2mmの穴をあける (例)。
Drill holes with the specified diameter (here: 2mm).
- をカットする。**
Cut off shaded portion.
- A/B** エポキシ接着剤で接着する。
Apply epoxy glue.
- 注意して組立てる所。**
Pay close attention here!
- 警告**
Warning!
- 瞬間接着剤で接着する。**
Apply instant glue (CA glue, super glue).
- 重要な注意事項があるマ**
必ずお読みください。
Do not overlook this symbol!
- 可動するように組立てる。**
Ensure smooth non-binding movement while assembling.

The pre-covered film on ARF kits may wrinkle due to variations of temperature. Smooth out as explained below.

Use an iron covered with a cloth! Start at low setting. Increase the setting if necessary. If it is too high, you may damage the film.

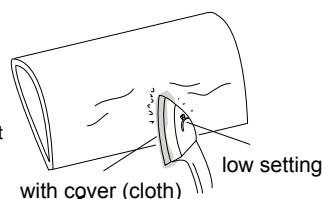

SPECIFICATIONS

Wing Span..... 2630mm(103")
Weight..... 1000g~1100g
Length..... 1130mm(44.5")
Wing Area..... 28.5dm²
Wing Loading..... 33~35g/dm²
Airfoil..... HQ 3012
Radio..... 3 channel, 4servos

- Horn** 5
- Linkage stopper** 5
- 2.6 x 12mm TP Screw** 13
- 3 x 18mm screw** 2
- 6 x 600mm Carbon rod** 1
- 3 x 30mm Wire** 4
- 1 x 1000mm wire** 2
- 1 x 90mm wire** 3
- Hook** 2
- 3mm plywood** 1
- rubber band** 2

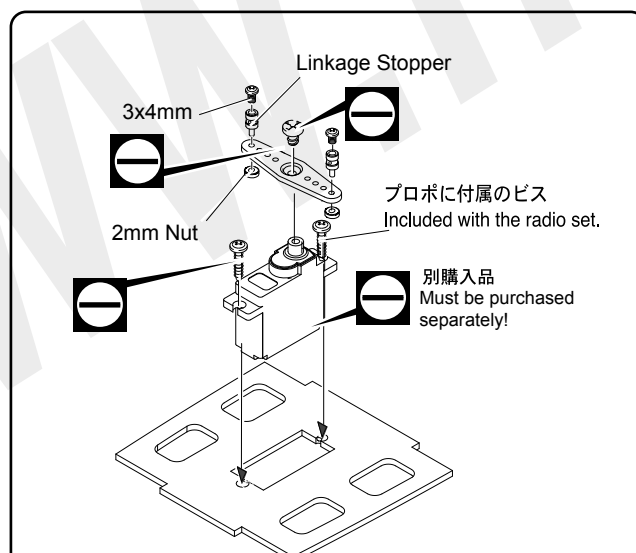

The CG position will vary depends on your requirement. Move the CG to achieve your control style.

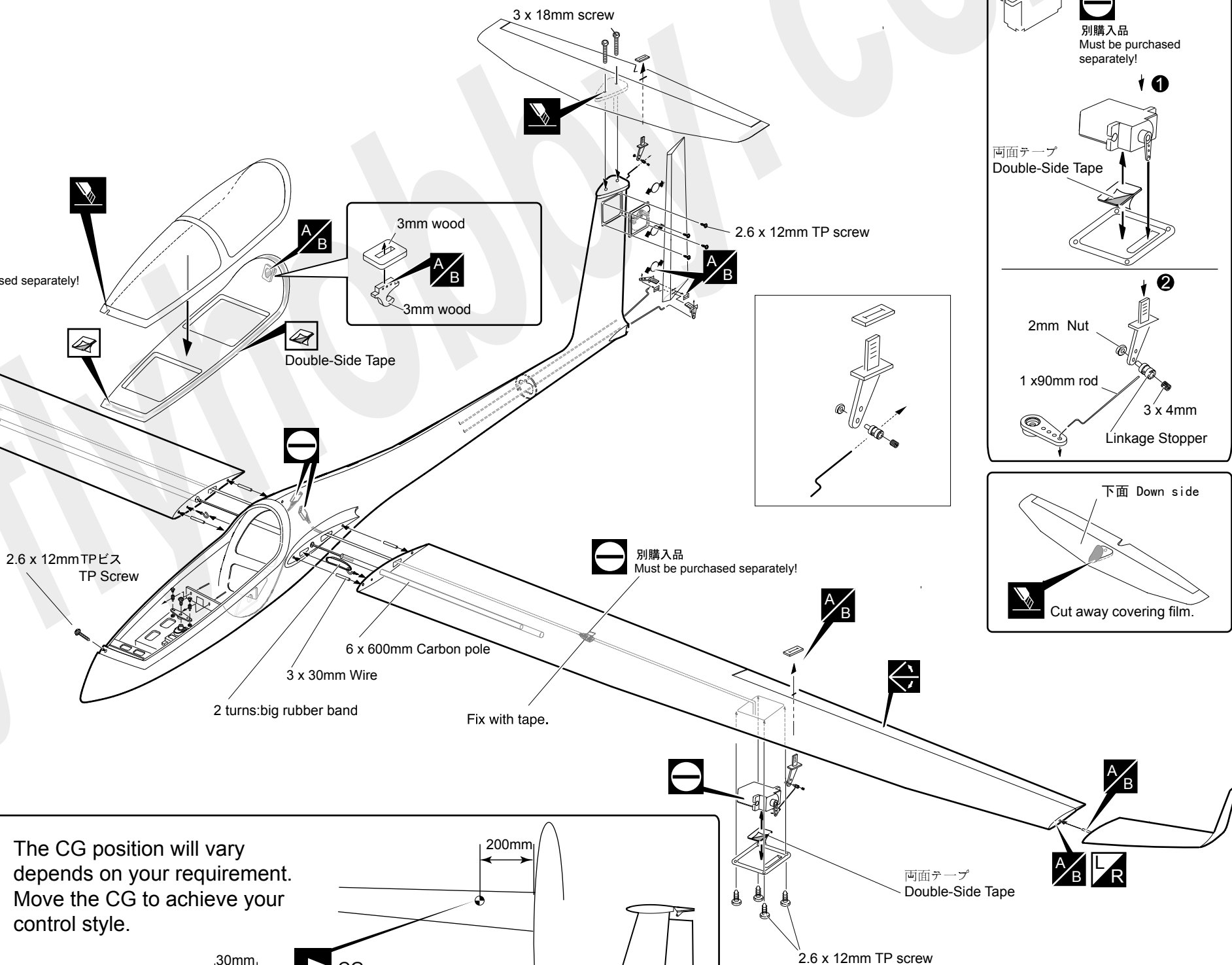
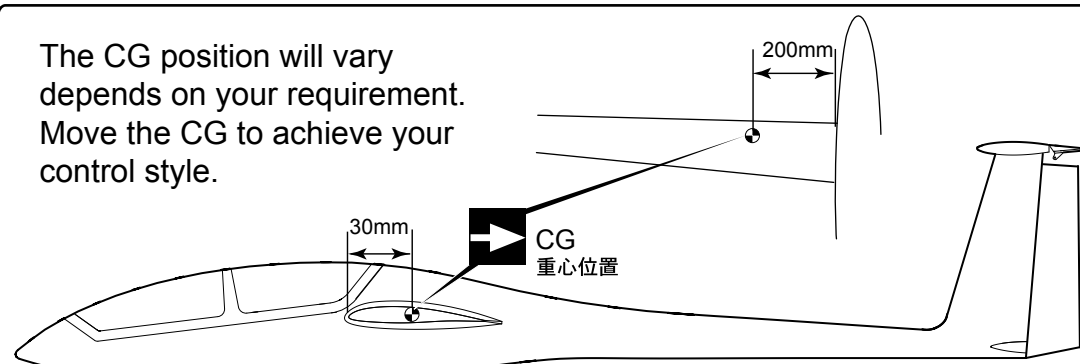

Designed and Manufactured by :
FlyFly Hobby Mfg.
info@flyflyhobby.com
http://www.flyflyhobby.com

